

**User Inspection Notice**  
**MSA V-EDGE® Web PFLs**  
August 2025  
**PLEASE READ NOW AND TAKE ACTION**

**MSA Corporate Center**  
1000 Cranberry Woods Drive  
Cranberry Township, PA 16066  
800.MSA.2222  
www.MSAafety.com

**Dear MSA Fall Protection Customer,**

MSA is issuing this Inspection Notice to alert you to the need for an additional step in your pre-use checks and examination procedures regarding your MSA V-EDGE Web PFLs (Personal Fall Limiters) that were manufactured between May 2018 up to and including January 2025. See appendix for individual model numbers.

MSA has received an isolated field report that a bolt that connects the PFL ring to the Energy Absorber of the V-EDGE Web PFL separated from the unit, resulting in the unit being non-functional. **MSA has not received any reports of injuries associated with this condition. However, we request that you perform the inspection outlined in this notice prior to your next use and include it in your pre-use checks and examination procedures.**



**Figure 1: V-EDGE Web Personal Fall Limiter (PFL)**

**MSA is advising all customers to inspect for the presence of the silver roll pin during pre-use checks for MSA V-EDGE Web PFLs listed in this notice.**

**Inspect all units per the instructions in this notice prior to your next use. If any PFL does not pass this inspection, remove it from service and contact MSA.**

### **Inspection Procedure**

Perform the following inspection on your entire stock prior to next use to determine if any of your PFLs need to be taken out of service. This check should also be incorporated into your pre-use check and examination procedures moving forward.

**MSA Corporate Center**  
1000 Cranberry Woods Drive  
Cranberry Township, PA 16066  
800.MSA.2222  
www.MSAafety.com

- 1) **Confirm Model Number and Manufacturing Date** – Refer to Figure 2
  - a. **Model Number**
    - i. Confirm that your model number is listed in the table in the appendix.
    - ii. If your model number is not listed, no further action is needed.
  - b. **Manufacturing Date**
    - i. Confirm that your manufacturing date is between 05/2018 and 01/2025
    - ii. If the date is outside of this range, no further action is needed.

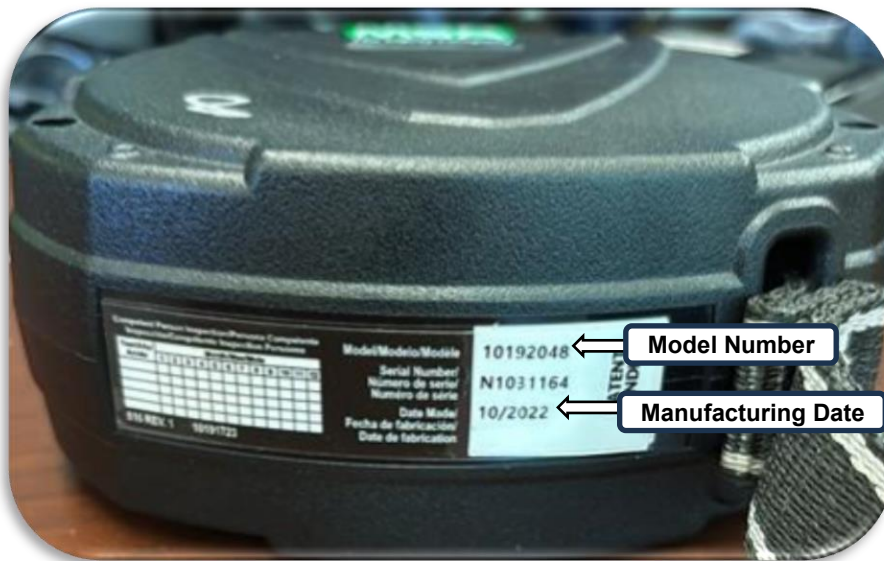

**Figure 2: Product Identification**

- 2) **Inspect the product** - Visually inspect the bolt that connects the PFL ring to the Energy Absorber of the V-EDGE PFL for the presence of the silver roll pin. (Figure 3)
- Roll pin is present and flush – Continue using product per manufacturer recommendations.
  - Roll pin is protruding or not present – Remove the product from service and follow the procedure below for a replacement unit.

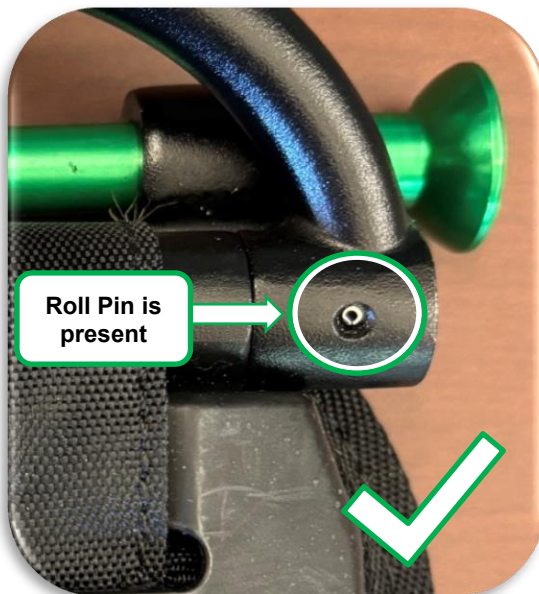

**Figure 3: Roll Pin Inspection**

Please remember to review the full user manual, 10191702, for all required inspection steps and frequencies.



## **Replacing Affected MSA V-EDGE Web PFLs**

If you are in possession of any MSA V-EDGE Web PFLs whose roll pin is not properly secured, we will replace them free of charge. In an effort to minimize any disruption, we pledge to take any replacement actions as expeditiously as possible.

**MSA Corporate Center**  
1000 Cranberry Woods Drive  
Cranberry Township, PA 16066  
800.MSA.2222  
[www.MSAafety.com](http://www.MSAafety.com)

Please note that the MSA V-EDGE Web PFLs included in this notice were discontinued in January 2025 when the V-TEC EDGE Web PFL was launched. Any replacements needed will be provided using a current and equivalent MSA V-TEC EDGE Web PFL.

**To receive a replacement, please contact MSA as shown below.** Replacement PFLs will be shipped to you, and we will forward you instructions for returning the same quantity of affected PFLs.

### **MSA Customer Service Contact Information**

If you have any questions regarding this Inspection Notice, please contact us as shown below:

**US and Canada:** call 866-672-0005 or Email us at [ProductSafetyNotices@msasafety.com](mailto:ProductSafetyNotices@msasafety.com)

**Europe, Middle East, and Africa:** Email us at [ProductUserNotice@msasafety.com](mailto:ProductUserNotice@msasafety.com)  
or contact your local MSA customer service representative

**All other regions:** Contact your local MSA customer service representative.

Thank you for your continued trust in our products

Best regards,

A handwritten signature in black ink, appearing to read "Adam Troup".

Adam Troup  
Product Safety Manager

## Appendix: Potentially Affected Model Numbers

**MSA Corporate Center**  
1000 Cranberry Woods Drive  
Cranberry Township, PA 16066  
800.MSA.2222  
[www.MSAafety.com](http://www.MSAafety.com)

| Material | Description                                     |
|----------|---|
| 10192006 | PFL, V-EDGE, WEB, 8FT, AL36CL, ANSI             |
| 10192007 | PFL, V-EDGE, WEB, 8FT, AL36CL, CSA              |
| 10192008 | PFL, V-EDGE, WEB, 2.4M, AL36CL, EN              |
| 10192009 | PFL, V-EDGE, WEB, 8FT, TWIN, AL36CL, ANSI       |
| 10192010 | PFL, V-EDGE, WEB, 8FT, TWIN, AL36CL, CSA        |
| 10192011 | PFL, V-EDGE, WEB, 2.4M, TWIN, REBAR ALSWLEN     |
| 10192012 | PFL, V-EDGE, WEB, 8FT, 36C, ANSI                |
| 10192013 | PFL, V-EDGE, WEB, 8FT, 36C, CSA                 |
| 10192015 | PFL, V-EDGE, CINTA, 2.4 DOBLE, 36C, ANSI        |
| 10192022 | PFL, V-EDGE, WEB, 8FT, AL SWV CARAB, ANSI       |
| 10192024 | PFL, V-EDGE, WEB, 2.4M, AL SWV CARAB, EN        |
| 10192025 | PFL, V-EDGE, WEB, 8FT, TWIN, AL SWV CARAB, ANSI |
| 10192027 | PFL, V-EDGE, WEB, 2.4M, TWIN, AL SWV CARAB, EN  |
| 10192032 | PFL, V-EDGE, WEB, 8FT, AL CARAB, ANSI           |
| 10192039 | PFL, V-EDGE, WEB, 8FT, SM SWV HOOK, ANSI        |
| 10192040 | PFL, V-EDGE, WEB, 8FT, SM SWV HOOK, CSA         |
| 10192041 | PFL, V-EDGE, WEB, 2.4M, SM SWV HOOK, EN         |
| 10192042 | PFL, V-EDGE, WEB, 8FT, TWIN, SM SWV HOOK, ANSI  |
| 10192043 | PFL, V-EDGE, WEB, 8FT, TWIN, SM SWV HOOK, CSA   |
| 10192044 | PFL, V-EDGE, WEB, 2.4M, TWIN, SM SWV HOOK, EN   |
| 10192048 | PFL, V-EDGE, WEB, 8FT, 36CL, ANSI               |
| 10192049 | PFL, V-EDGE, WEB, 8FT, 36CL, CSA                |
| 10192050 | PFL, V-EDGE, WEB, 2.4M, REBAR, SWL, EN          |
| 10192051 | PFL, V-EDGE, WEB, 8FT, TWIN, 36CL, ANSI         |
| 10192052 | PFL, V-EDGE, WEB, 8FT, TWIN, 36CL, CSA          |
| 10192053 | PFL, V-EDGE, WEB, 2.4M, TWIN, REBAR SWL, EN     |
| 10192516 | PFL, V-EDGE, WEB, 9FT, TWIN, FP5K, ANSI         |
| 10192519 | PFL, V-EDGE, WEB, 9FT, FP5K, ANSI               |
| 10227165 | PFL, V-EDGE, WEB, 8FT, TWIN, COATED HOOK, ANSI  |